



Novotel Melbourne Preston
Melbourne's North



Novotel Melbourne Preston



Novotel Melbourne Preston is ideally located in Melbourne's vibrant inner north, offering 383 modern guest rooms and suites with sweeping views across the city skyline and Dandenong Ranges, enhanced by abundant natural light.

Designed for both comfort and functionality, the hotel underwent a \$30 Million renovation in 2022 and features contemporary interiors, 15 meeting & event spaces, alongside a range of onsite amenities including a restaurant, café, 24-hour gym, sauna, salon, postal office and 400 secure car spaces.



Just 25 minutes from Melbourne CBD and Melbourne International Airport, the hotel is exceptionally well connected, with tram, train and bus options within walking distance, along with 400 car spaces on-site.

Parallel to the 'The World's Coolest Street' (Timeout, 2024) discover High Street's dining and retail precinct and close to Northland Shopping Centre, guests enjoy seamless access to local attractions, entertainment and everyday convenience, making Novotel Melbourne Preston the ideal choice for business, leisure, and event stays.



Novotel Melbourne Preston

Guest Rooms, Studios & Suites

Standard

40 Double
Avg. 23 Sqm

Find everything you need for an accommodation base in our cozy lead in rooms, giving you a perfect base to head out in Melbourne. Spread out among 7 levels, featuring an array of amenities.

Superior

33 Queen
50 King
63 Twin
Avg. 25 Sqm

Boasting modern features and filled with natural light, our superior rooms are located across levels 1 – 3 with a chaise lounge, spacious open plan living area, dedicated work space and large openable windows.

Deluxe

20 Queen
77 King
Avg. 28 Sqm

Occupying the higher floors on levels 5 and 6 with floor to ceiling windows allowing for plenty of natural sunlight and stunning views across Melbourne City or Macedon ranges. Enjoy spacious open plan living, a dedicated work space & Nespresso coffee facilities in these rooms.

Studio Apartments

50 Queen, King
Avg. 28 Sqm

Positioned on Level 4, these fully equipped studios combine the comfort of home with the luxury of hotel facilities and services. Boasting an open plan with openable windows to a view across Melbourne and its surroundings.

All studios feature a self-contained kitchenette with a stove top, microwave, fridge, Nespresso coffee machine, lounge and dining, LED Smart TV with Chromecast, multiple USB hubs for conveniently charging your devices, in-room safe, and dedicated work space. Both short and long term residents will enjoy laundry facilities with washer and dryer.

Deluxe Double Double

31 Double Double,
/ King + 2 Singles

This Deluxe room spans across the first 6 levels of the hotel offering some of our largest rooms, and a spacious layout for families or those wanting to share a room. You'll be delighted by the configuration options to suit any group with two double beds, or a king bed and two singles.

Deluxe Suites

15 Queen or King

Occupying levels 5 and 6 with floor to ceiling windows for natural sunlight and views across Melbourne City or Macedon ranges. Open plan living featuring LED Smart TV with Chromecast, multiple USB hubs throughout, built-in desk, Nespresso machine, mini-fridge and in-room safe.

Executive Suites

4 King
Avg. 20 Sqm

Elevated style, amenity inclusions and positioned of the 7th floor of the hotel. Discover private roof top balconies, these suites are generous in size and boast an open and light feel atmosphere.

Awake from your spacious king bed, enjoy your morning caffeine fix with in-room Nespresso machines and enjoy sky-high views over Melbourne City or right through to the Macedon and Yarra ranges.

These suites offer a spacious living and working area for an indulgent getaway, discerning business trip, or comfortable space for work and play.



Novotel Melbourne Preston

OUR ROOMS



Standard Double



Superior Twin



Deluxe King



Deluxe Double Double



Novotel Melbourne Preston

OUR ROOMS



Deluxe Queen



Deluxe Suite



Studio Apartment



Executive Suite



Novotel Melbourne Preston

Meetings & Events



Seamless Spaces

15 Event venues

Pillarless, light-filled spaces to host between 10 to 500 guests. Ideal for plenary sessions and multiple breakouts, rooms. Can be set in theatre, U-shape, boardroom, classroom, banquet, and cabaret styles, alongside a dedicated auditorium.

All equipped with AV and Wi-Fi, with a dedicated events team supporting from planning to execution.



Find Balance

Flexible dining

All day dining from buffet breakfast through to dinner in The Stampton, with barista coffee and ready to go options at Stampton & Co. cafe. Plus event menus made in-house for cocktail functions, conferencing and plated meals.

All menus offer 25% plant-based options.

Capacity of the meeting rooms in number of guests:

	Area	Height	Theatre	U-shape	Board room	Class room	Cabaret	Banquet
The Market	395	4	500	120	—	200	240	300
Market 1	185	4	200	50	—	110	112	140
Market 2	95	4	100	40	—	50	48	60
Market 3	115	4	100	40	—	50	64	80
Courtyard 1, 2, 3	238	2.6	240	60	—	140	136	170
Courtyard 1	89	2.6	90	27	—	54	48	60
Courtyard 2	64	2.6	60	21	—	36	32	40
Courtyard 3	96	2.6	90	27	—	50	48	60
Courtyard 4	268	2.6	200	45	—	100	120	150
Garden 1	—	—	—	—	8	—	—	—
Garden 2	68	3	70	30	—	39	48	60
Garden 3	60	3	60	24	—	33	40	50
Garden 4	90	3	90	42	—	54	64	70
Garden 5	98	3	100	42	—	60	64	—
The Auditorium	98	3	100	—	—	—	—	—



Novotel Melbourne Preston

The Market

Available as one grand space with its own private pre-function area or can be separated into 3 large function areas. This pillarless ballroom features floor to ceiling windows, a balcony, private foyer, bar and bathrooms, plus direct lift access from the on-site car park.



Market 1 & 2



Market 2



Market 2 & 3



Novotel Melbourne Preston
The Market Floorplan

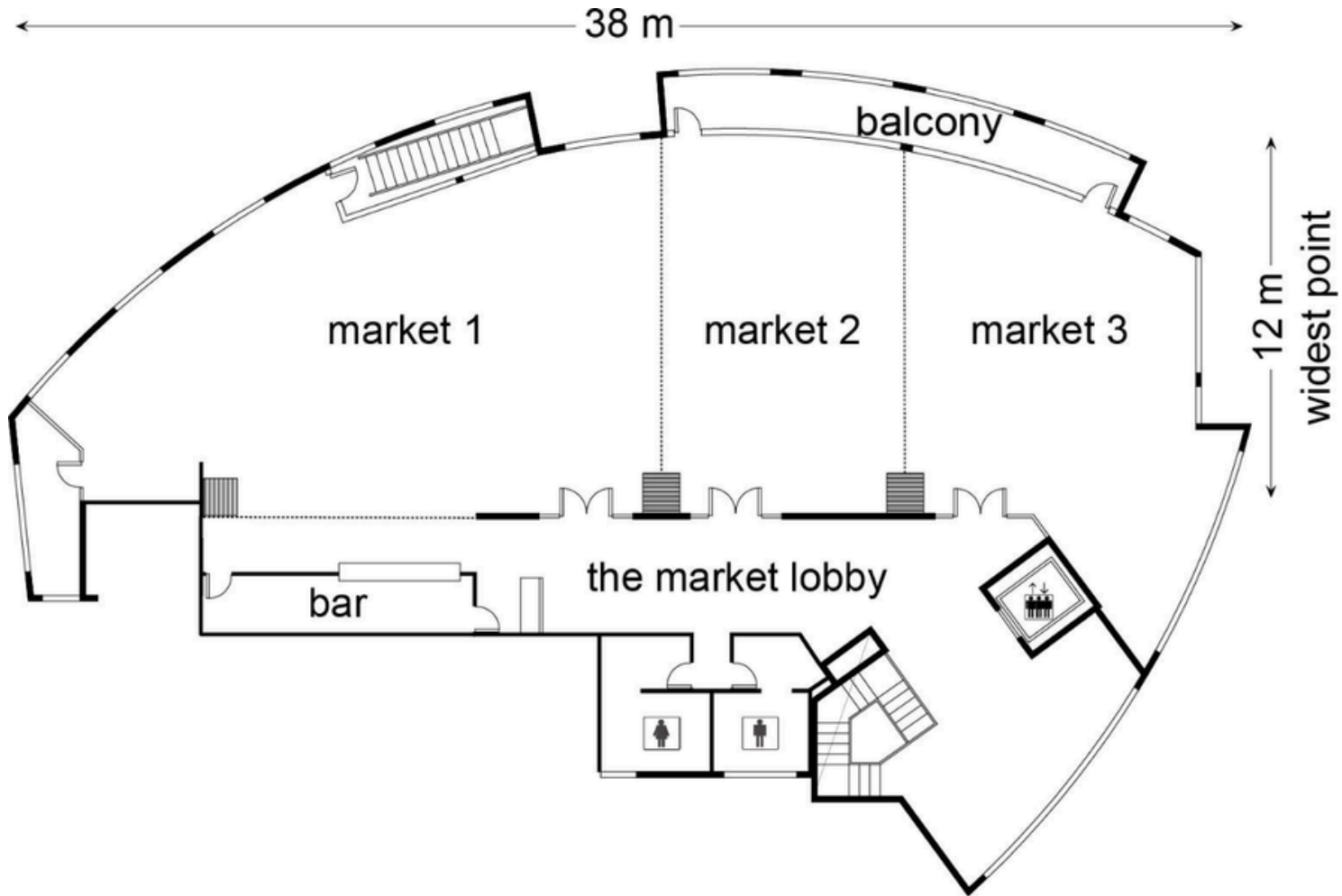

Novotel Melbourne Preston

The Courtyards

Enjoy floor to ceiling natural light, with the first 3 spaces opening to a shared breakout or pre-function foyer. The 3 rooms can open into one large function space, or divide for breakout areas.



Courttyard 4 The unique L shape and natural light keeps this space open and flexible for a multitude of event types such as team building, expos, workshops and conferences. Offering plenty of space for groups to break apart or work together, plus space for catering in the same area. Courttyard 4 opens out to the Courtyard Terrace.



Novotel Melbourne Preston
The Courtyards Floorplan

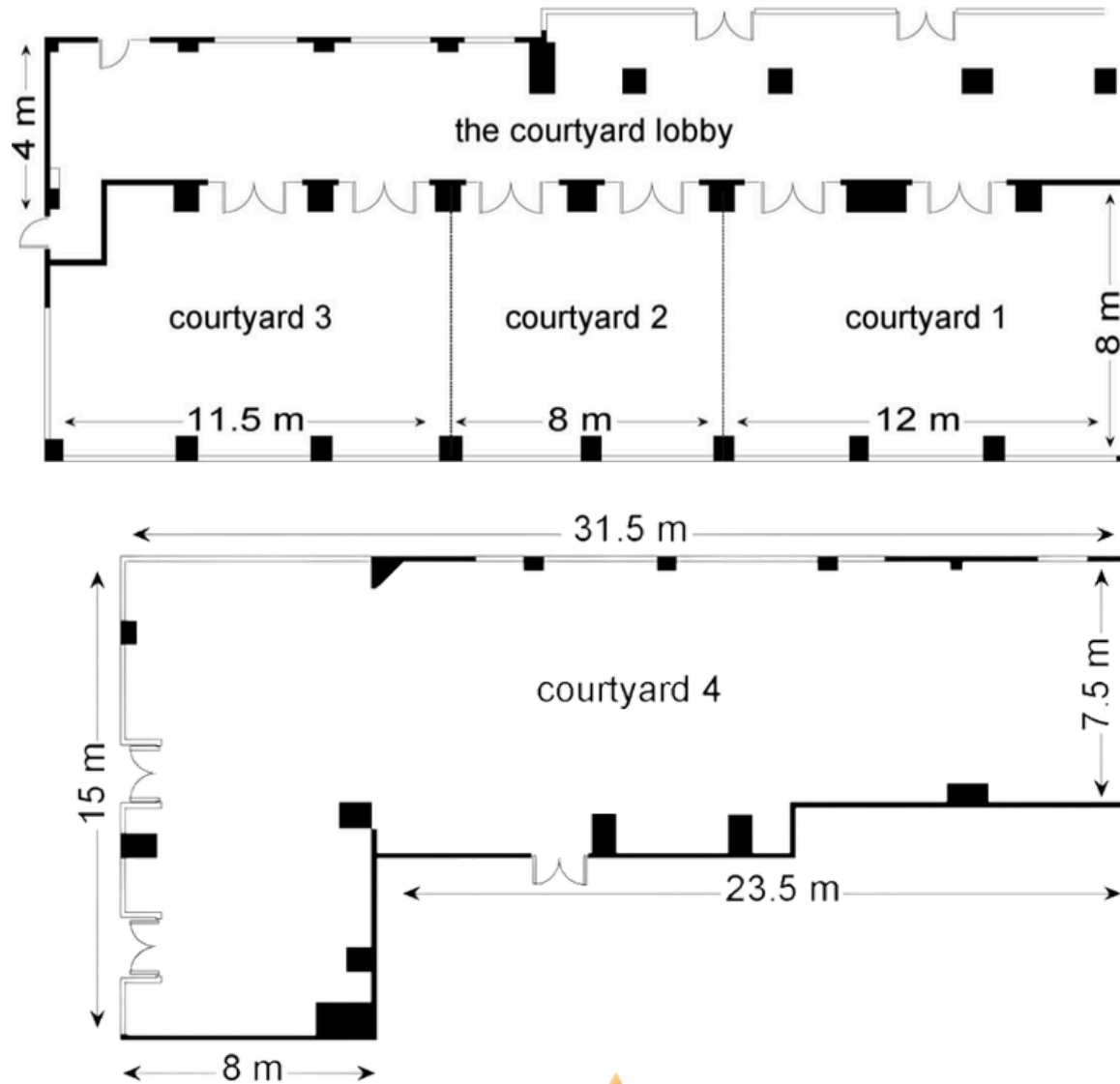

Novotel Melbourne Preston

The Gardens & Auditorium

The Garden spaces are filled with natural light, entering from and overlooking the Gardens with share two receptions for catering breaks.



Garden 1



Garden 2



Garden 3 and 4



Garden 5

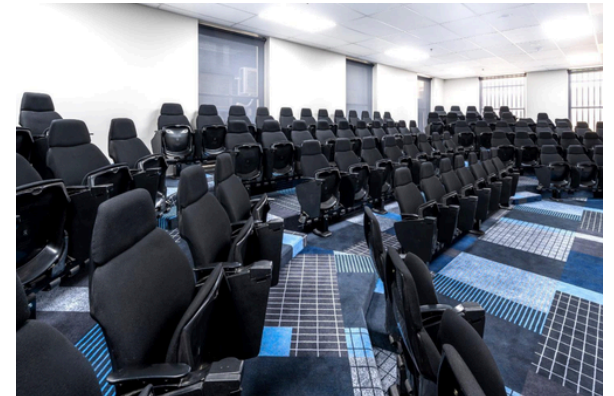

The Auditorium features tiered seating with are chairs fitted with pull our trays for notetaking. Perfect for lectures, seminars and presentations. Catering up to 100 delegates with 5 breakout rooms in the adjacent spaces.



Novotel Melbourne Preston
The Gardens Floorplan

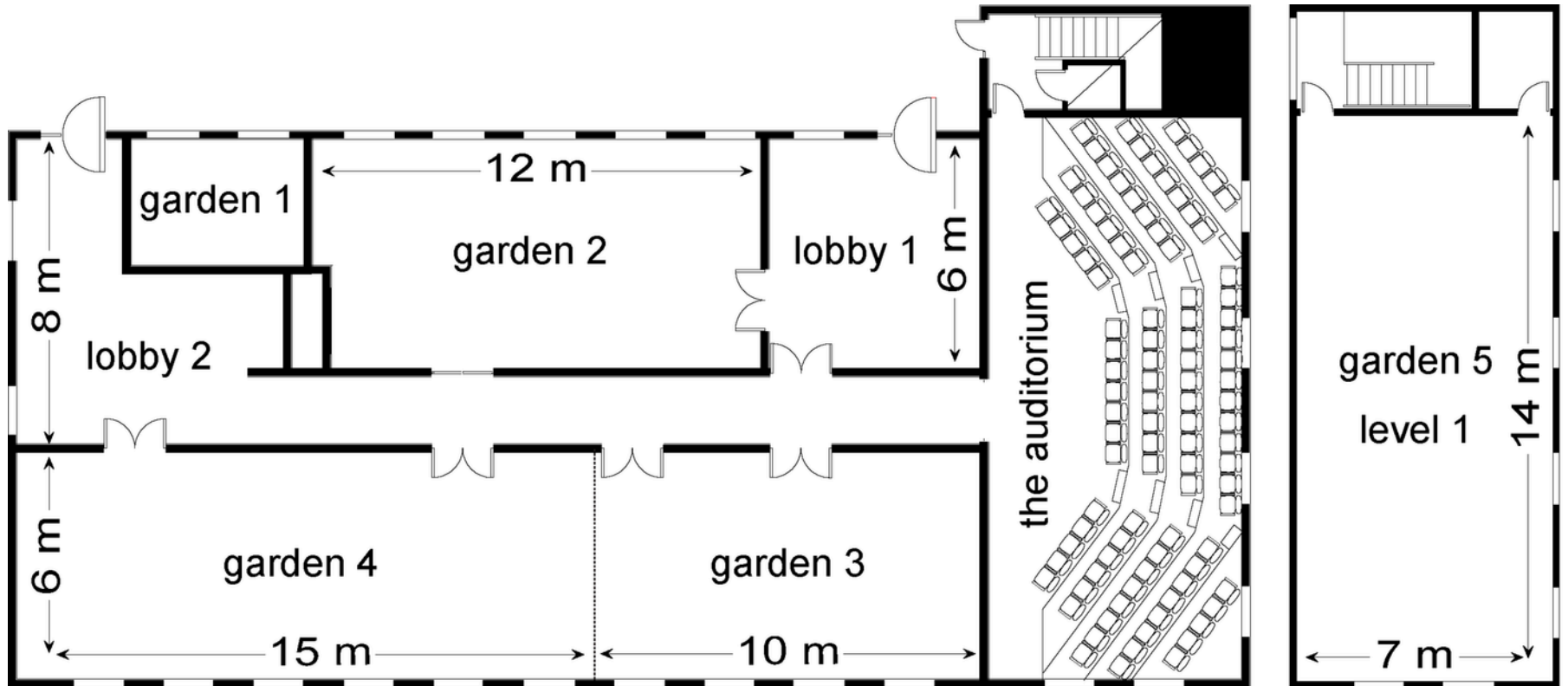

Facilities



ON SITE GYMNASIUM & SAUNA



24HR STAFFED RECEPTION



24HR ROOM SERVICE



400 ON SITE CAR SPACES



STAMPTON & CO CAFE
7AM - 2 PM DAILY



THE STAMPTON RESTAURANT & BAR
7AM - 10PM DAILY



ON SITE POSTAL OFFICE



15 FUNCTION, MEETING & EVENT SPACES



GUEST LAUNDRY FACILITIES



SUSTAINABILITY CERTIFIED



FLEXIBLE WORKING SPACES IN LOBBY

OUR ROOMS



383 GUEST ROOMS



SMART TV WITH CHROMECAST



USB HUBS IN ROOM



COMPLIMENTARY HIGH SPEED WI-FI



COMPLIMENTARY BATHROOM AMENITIES

CONTACT



TEL: (03) 9 4 8 5 1 0 0 0



RES: Hb3k5@accor.com

EVENTS: Hb3k5-sb@accor.com





RAFFLES \ ORIENT EXPRESS \ BANYAN TREE \ DELANO \ SOFITEL LEGEND \ FAIRMONT \ SLS \ SO \ SOFITEL \ RIXOS
ONEFINESTAY \ MANTIS \ MGALLERY \ 21C \ ART SERIES \ MONDRIAN \ PULLMAN \ SWISSÔTEL \ ANGSANA \ 25HOURS HOTELS
HYDE \ MÖVENPICK \ GRAND MERCURE \ PEPPERS \ THE SEBEL \ MANTRA \ NOVOTEL \ MERCURE \ ADAGIO
MAMA SHELTER \ TRIBE \ BREAKFREE \ IBIS \ IBIS STYLES \ IBIS BUDGET \ JO&JOE \ HOTELF1