

[THE OLSEN]

CONFERENCE KIT

# Meetings and events





[ THE OLSEN ]

# Meetings and events



Featuring award-winning interior design, The Olsen is nestled at the north end of Melbourne's iconic Chapel Street precinct. Adorned with the lyrical artwork of one of Australia's premiere painters: John Olsen, our unique event spaces offer numerous, flexible set ups flooded with natural light. Ideal for launches, shows and seminars, or week-long boutique residential conferences, The Olsen's nine inspiring spaces provide the perfect backdrop for an event a little extraordinary.

---

## CONFERENCE, MEETING & EVENT FACILITIES

-----

- 8 inspiring conference and event spaces
- Boutique spaces for up to 300 people
- Flexible setup options
- Stunning Melbourne views
- Wall mounted flat screen TVs with data connections
- Data projector and screen
- Individual heating and cooling systems
- Whiteboard and flipchart
- Free wifi access
- Automatic retractable blinds in Penthouse
- Invaluable event management expertise
- Mouth watering in-house catering
- Inspiring artworks in all event spaces
- Close to public transport
- On-site parking





## [ THE OLSEN ]

### **GALLERIES I – III**

The Olsen Galleries I, II and III provide sophisticated executive spaces in the heart of cosmopolitan South Yarra. From boardroom to banquet they offer flexible setups, and a variety of catering options. Hired individually or transformed into one versatile space, our galleries are sure to impress.

### **GALLERY IV**

The Olsen's Gallery IV is a unique space drenched in sunlight. Featuring floor to ceiling glass walls and views across the azure blues of our glass bottom pool, this distinctive space is ideal for media calls, fashion launches, and blue sky brainstorming.

### **LEVEL ONE-COURTYARD & POOLSIDE**

Overlooking the glass bottom pool, The Olsen's Courtyard and Poolside is an al fresco space featuring stylish designer decor and contemporary furniture. A canopy roof and gas-heating respond to Melbourne's ever changing weather. Simply perfect for cocktail events.

### **JOHN OLSEN PENTHOUSE**

Located on the top floor, take pleasure in spectacular sweeping Melbourne CBD skyline views, and soak your worries away in the balcony spa whilst looking over Chapel Street. Ideal for private dining, cocktail events and high-end meetings.

### **LAKE EYRE PENTHOUSE**

Be inspired and mesmerised by the sheer size and style of the Lake Eyre Penthouse. From the expansive Melbourne city skyline to the plunge pool and every little creature comfort in-between, Lake Eyre Penthouse provides an unforgettable setting for intimate dining, cocktail events and sophisticated meetings.

### **SPOONBILL**

Our signature restaurant and bar, Spoonbill highlights Australia's seasonal produce and is available for functions large and small. The private dining room is the perfect escape for that special occasion or intimate gathering.



# [ THE OLSEN ]

Spaces	Dimensions MxM	Gross Area Sq M	Capacity (Number of Persons)							Fashion Launch /Showings
			Boardroom	Theatre	Classroom	Banquet	Cabaret	U-Shape	Cocktail	
Gallery I	6 x 6	35	6	16	12	8	8	9	20	√
Gallery III	4.4 x 7	30	14	25	12	8	8	15	20	√
Gallery IV	10 x 4	40	18	40	12	16	16	21	40	√
Level One	-	170	-	140	-	90	90	-	300	√
John Olsen Penthouse	-	156	24	40	21	36	32	19	80	√
Lake Eyre Penthouse	-	144	16	40	20	-	16	22	80	√
Spoonbill	17 x 11	180	14	-	-	-	-	-	150	√
Private Dining Room	-	-	16	-	-	-	-	-	35	√
Gallery I & II	10 x 5.5	55	24	30	21	21	21	21	40	√
Gallery II & III	8.4 x 6	50	18	30	15	16	16	15	30	√
Galleries I, II & III	14 x 6	85	30	50	27	56	56	27	70	√

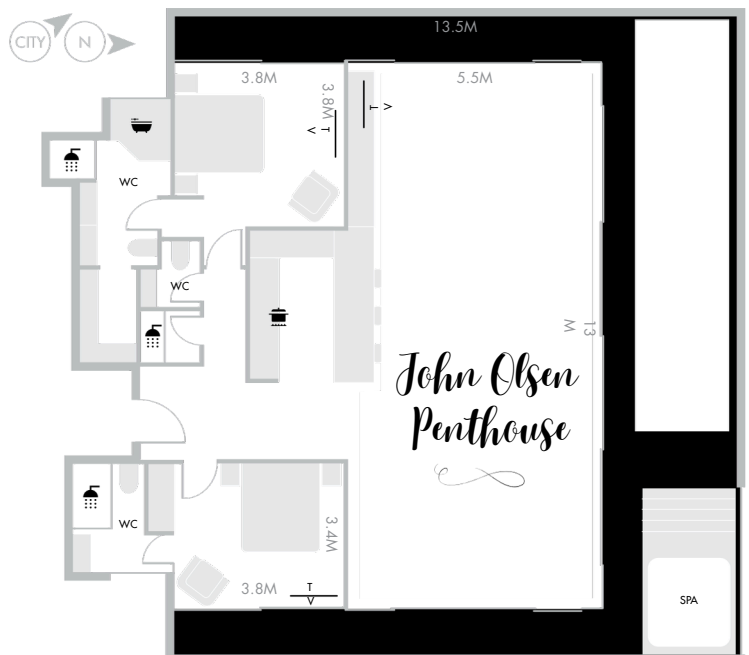

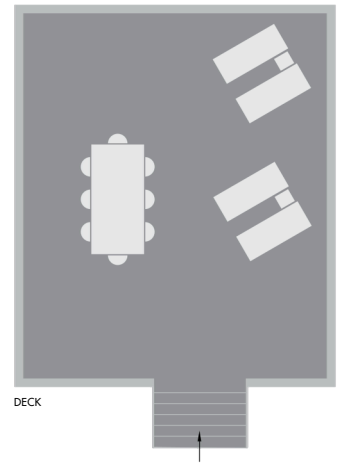





# Day Delegate Package



## DAY DELEGATE SAMPLE MENU

### MORNING TEA

- Ham, cheese and tomato croissants
- Assorted house made muffins
- Fresh fruit bowl

### LUNCH

- Beef Bourguignon, mushroom and cocktail onion
- Potato lyonnaise
- Nicoise salad
- Custard tarts
- Assorted soft drinks

### AFTERNOON TEA

- Wild mushroom and brie tarts
- Pecan and espresso slice

For meetings of 20 people or more, our Day Delegate Package includes:

- Room hire
- Nespresso Tea & Coffee
- Morning tea, lunch and afternoon tea
- Flip chart
- Whiteboard
- Data projector and screen

---

Wanting to cater for less than 20 people? Ask us about our flexible package options.

### ENQUIRE TODAY

Call the Conferences & Events team on (03) 9040 1222  
[olsen.events@artserieshotels.com.au](mailto:olsen.events@artserieshotels.com.au)



[THE OLSEN]

# Evening Events



## CANAPES AND PLATTERS

Our flexible packages offer a stylish way to entertain, featuring a curated selection of elegant hot, cold and substantial bites crafted with premium seasonal ingredients. Perfect for cocktail events, corporate gatherings, and celebrations, each menu is designed for effortless mingling and memorable flavours.

## SAMPLE CANAPE MENU

- Rare beef, garlic crostini, onion jam, dijonnaise
- Wild mushroom and thyme arancini, aioli
- Crispy rockling taco, tomato corn salsa, lime aioli
- Jamon and manchego croquette, chipotle mayo
- Dr Olsen's paella
- Hazlenut meringue, kahlua cream

## PLATTERS

- Antipasto
- Cheese board
- Savoury pastry board
- Fruit platter
- Sandwich and wrap platter



SPOONBILL





[THE OLSEN]

# Evening Events



## DINNER

Our dinner packages offer a refined dining experience with the choice of a 2–3 course plated menu or a 4–5 course shared-style feast. Designed around seasonal ingredients and contemporary flavours, each menu is crafted to create a memorable and relaxed dining experience for your guests.

## SAMPLE PLATED MENU

Entree

- Chorizo, chive and cheddar croquette, romesco
- Lamb cutlets, pumpkin puree, fatoush, sumac yogurt

Main

- Crispy pork belly, fennel puree, apple watercress slaw, jus gras
- Pumpkin, spinach and goat's cheese risotto, sage, pepitas

Dessert

- Lemon tart, raspberry compote, vanilla creme, lemon balm
- Taste of chocolate, crumb gelato, gateaux

## SAMPLE SHARED MENU

- Zucchini fritters, peas, cucumber and garlic yoghurt, pickled zucchini
- Zaatar spiced lamb rump, chipotle hummus, seasonal baby veg
- Vanilla panna cotta, mango lychee salsa, ginger crumb





# Drinks



## BEVERAGE OPTIONS

Offering the flexibility of packages, bar tabs or beverages on consumption, every event style can be catered for at The Olsen. Our extensive drinks list ranges from house options to premium wines and spirits, and our talented team can work with you on the perfect cocktails for your event.

## SAMPLE BEVERAGE LIST

- Santa & D'Sas Prosecco
- Veuve Clicquot Champagne
  
- Muna Muna Sauvignon Blanc
- Eden Hall Riesling
  
- Radio Boka Tempranillo
- Levantine Hill Estate Pinot Noir
  
- Furphy Ale
- Birra Moretti
- Pipsqueak Apple Cider
  
- Aperol Spritz
- Espresso Martini
- Passionfruit Collins
- Sangria (White or Red)

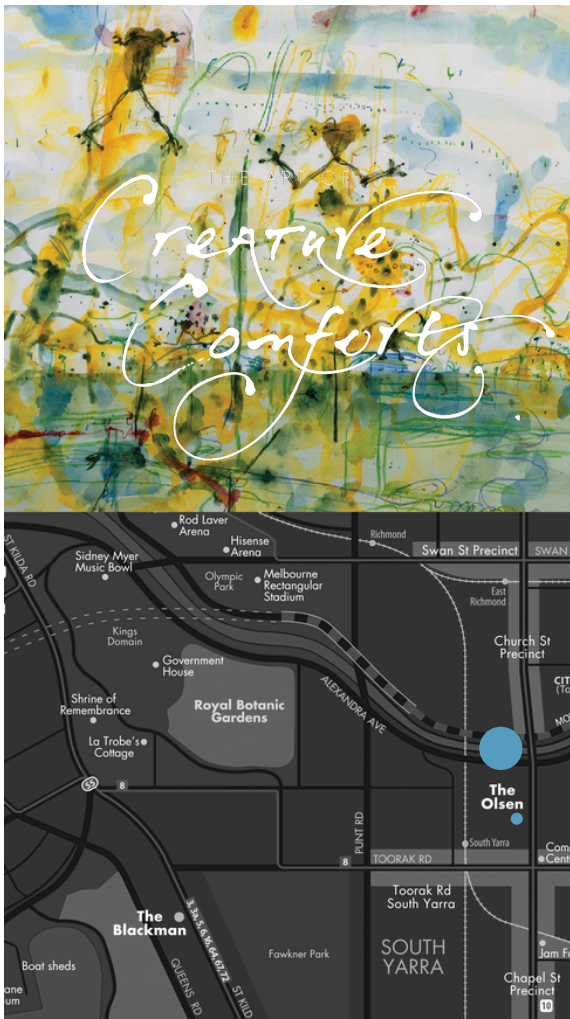

## ROOM FEATURES



- Modern kitchen facilities including microwave and stovetop, cooking utensils and crockery
- Delectable local mini-bar treats
- In-house art channel
- WiFi internet
- 42-inch LCD television
- Movies on demand
- Luxurious Art Series signature bedding
- Pillow menu
- Private ensuite bathrooms
- Individually controlled heating/cooling
- Private balconies (select room types only)
- Floor to ceiling windows
- Plentiful natural light and opening windows
- Work desk and lamp
- Black out curtains
- Museum quality archival John Olsen giclee prints adorning the walls
- Art library

## ROOM STYLES



### STUDIO SUITE

Open plan suite with designer furnishings, a queen size bed and a combined living and working space with plenty of natural light and fresh air

### DELUXE STUDIO SUITE

Open plan suite with a little more space, features a king size bed, plenty of natural light and fresh air and a combined living and working space.

### DELUXE STUDIO SUITE TWIN

Features two queen size beds in a separate space, plenty of natural light and fresh air and a combined living and working space.

### STUDIO SUITE BALCONY

Features two queen size beds in a separate space, plenty of natural light and fresh air and a combined living and working space.

### ONE BEDROOM SUITE

This spacious suite offers a separate bedroom and living and working space. Enjoy a king size bed, plenty of natural light and fresh air.

### SPA STUDIO SUITE

Enjoy your very own private spa located on an enclosed outdoor terrace in your studio suite. This open plan room features a king size bed and a combined living and working area.

### DELUXE SPA STUDIO SUITE

Enjoy your very own private spa located on an enclosed outdoor terrace in your Deluxe Studio Suite. The spacious open plan room features a king size bed and a combined living and working area.

### TWO BEDROOM OPEN PLAN SUITE

Featuring private en suites (one with bath), the open plan suite offer two king size beds separated by a spacious living area. The room boasts 180-degree views of Chapel St and plenty of natural light and fresh air.

### TWO BEDROOM DELUXE BALCONY SUITE

More like a spacious apartment, this suite offers two private bedrooms with king size beds, two bathrooms and a large living area. Enjoy views from your private balcony.

### THE OLSEN PENTHOUSE

The ultimate in premium five star living, The Olsen Penthouse offers two private bedrooms with king beds, two bathrooms, a laundry and a full size kitchen. The spacious living area opens onto an expansive terrace with a private spa, BBQ, and outdoor entertainment area.

## [ THE OLSEN ]

637-641 Chapel St  
 South Yarra VIC 3141  
 P: 03 9040 1222  
 artserieshotels.com.au

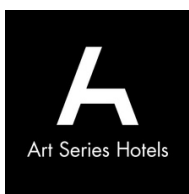

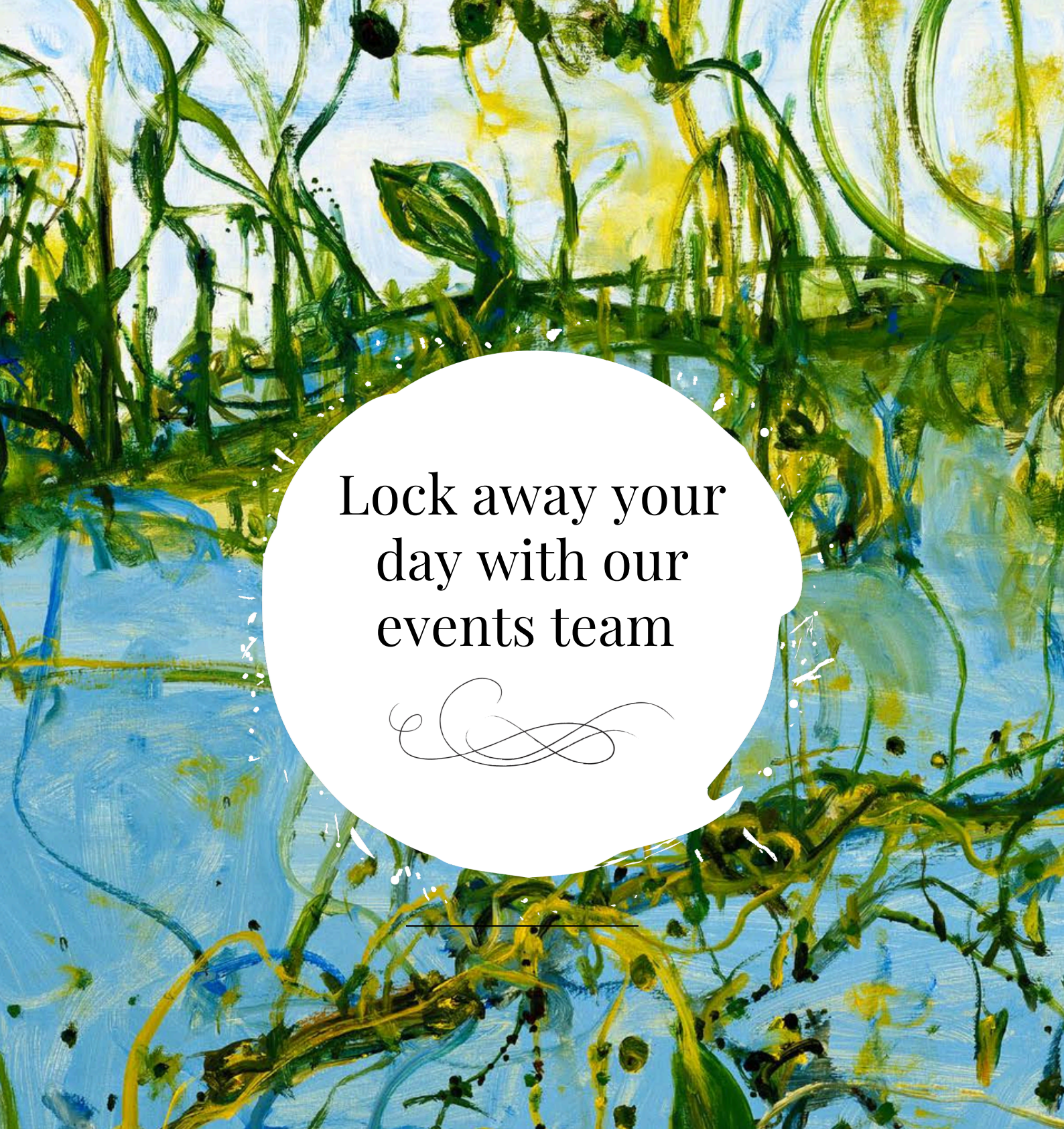

Lock away your  
day with our  
events team



[olsen.events@artserieshotels.com.au](mailto:olsen.events@artserieshotels.com.au)

or call on (03) 9040 1222

[ THE OLSEN ]